

Found 2-2" Tile

Set C.M. over 2-2" tile Laid Flat

Found C.M. 1' deep on SW side
of old car po. Set 3/4" pipe on
NW side of C.M. June 5, 1987
Garden Eng.

N.E. Cor 32-74-1B

Set Dec 4-1939

Notes: Kennedy

Party - Koons, Russell & Durham

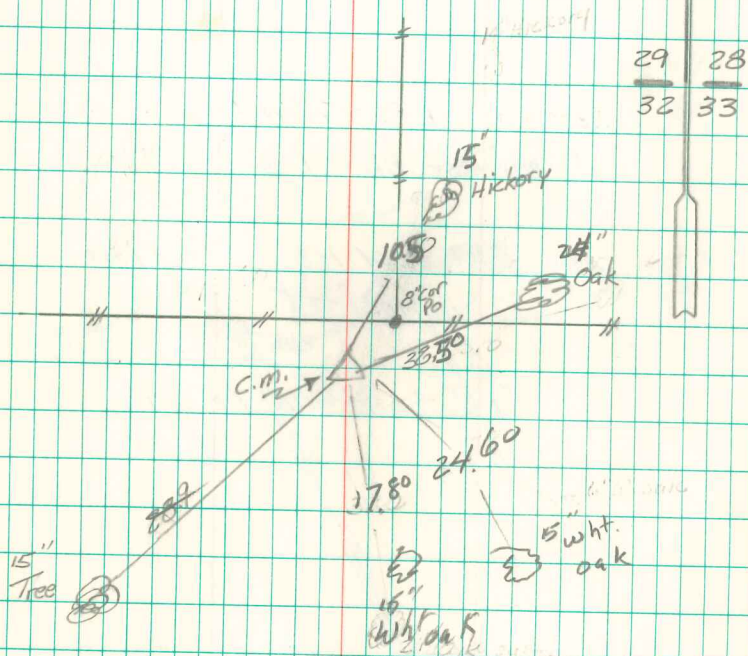

Abie

10/1/06