

N¹/₂ Cor 13-74-19
 Set - July - 20-42
 Notes - Kennedy
 Party - Palmer, Moss - Turner

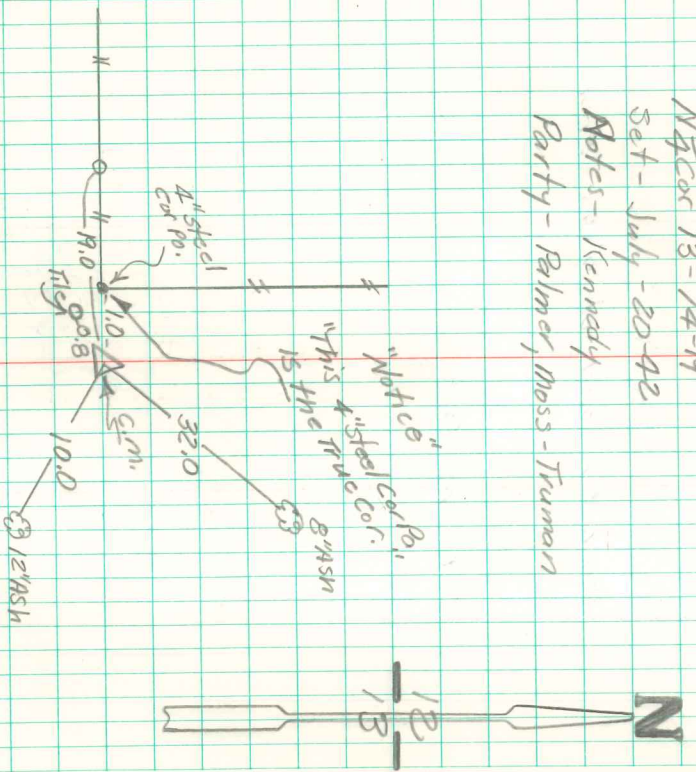

Dug hole in fence cor. 4'x4'x3' found
 Sand stone. set c.m. 1 Foot East
 of Cor Post. Put the stone on top
 c.m. 4'x8"x12"

Later: Aug 25-1942 Found 2" Ditch
 4" South of Steel Cor. Post. 3.5' Below
 Surface, 4 0.8ft West of conc. mon.
 as set July 20. I Release the Cor. P.
 was Set on True Corner.