

Center 6 - 74-19

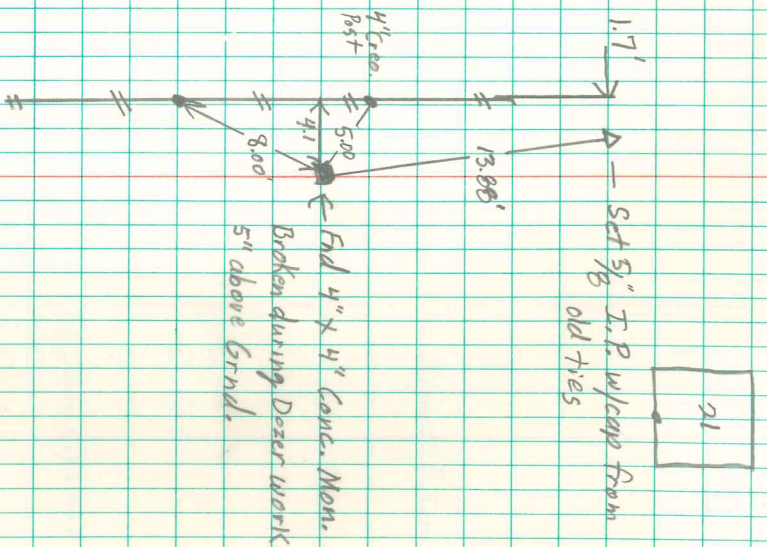

S4 Corner Sec 21-74-19

3/8/99



Found witness stone set by J.C. Nyg  
Rec. in Book No. Page 148

Set c.m. at witness cor marked  
w.t. cor. Put stone over c.m.

Set c.m. over 1/2" tile at true cor.  
in Ditch Put a sandstone 8x10x3"  
on top of c.m.

N<sup>1</sup>/<sub>2</sub> Cor 28-74-19  
Set - July - 6-1942  
Notes: Kennedy  
Party = Palmer, Moss & Turner

