

Dug a hole 8'x20'x2' deep at a Point indicated by Line & chaining. Found No evidence of Corner. Owners of adjacent land state the Hedge Fence on south side of road was set out on or near Line. Established the corner on proportional measurements from center of sec. 28 & 29 of survey made Dec. 4 1854 by F.M. Frush, & at same distance from S.E. cor. sec 29, as recorded in Survey Book B - Page 180. & in line with old established D.O. E. North & on Proportional Dist. from N.E. cor. sec.

Set c.m. over Broken Pieces of tile, with 3"x10"x12" Sandstone over c.m. 8" Below Surf.  
 2654.0' N. of cm. at S.E. cor sec.  
 2670.0' S. " " " N.E. " "  
 1334.0' S. "  $\frac{1}{4}$  cor E. West  
 2665.0' E. " D.O. E. N. From Ctr. Sec 29  
 2666.0' W. " " " " " " " 28

E $\frac{1}{2}$  Cor sec 29-74-19  
 Set oct-22-42  
 Notes - Earl Barker  
 Party = Zoute

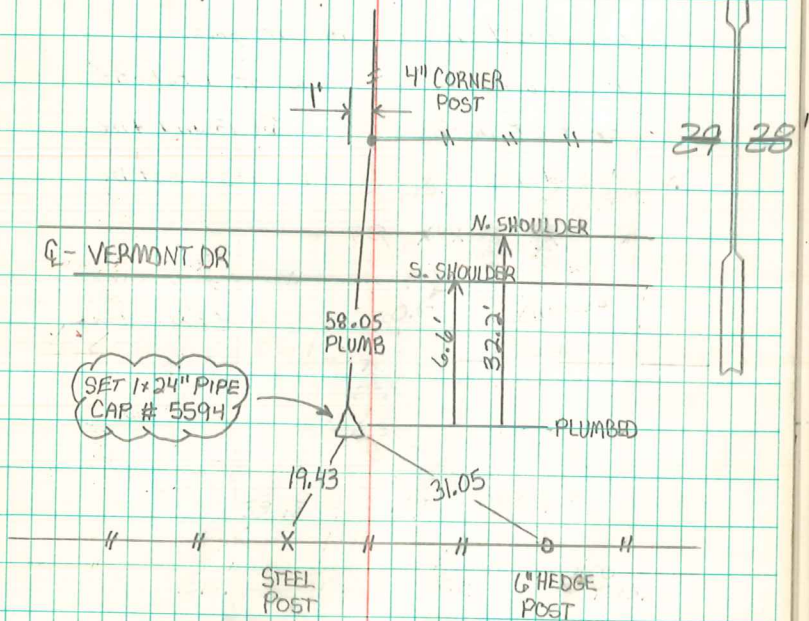

RE-TIED 6-13-12  
 ABIE C. DAVIS