

Dug hole 8'x10'x2' Deep on all sides  
 of Corner Posts to Dig Fences N.E.  
 § 10, Found No evidence. Found No  
 evidence, the corner evidently destroyed  
 in the setting of the many corner posts  
 that have been used for this Division E.

Found Stone 1/4 mile East, Produced line  
 from corner Post at Carter Sec 35  
 § Stone at 1/4 cor. which line comes  
 on south side of old corner Post

Reestablished Corner on line from East  
 § on line with old established Fence line  
 North.

Set 0.1 m. over 1-3" 7/16" with 6'x10'x15'  
 brown sand stone over c.m. 6" above Surf.

139.5' West of 1/4 Cor Stone  
 2654.0' " " Carter Sec 35

E 1/4 Cor 34-79-19  
 Set - Oct - 12-42  
 Notes - Kennedy  
 Barty - Parker, Shouts

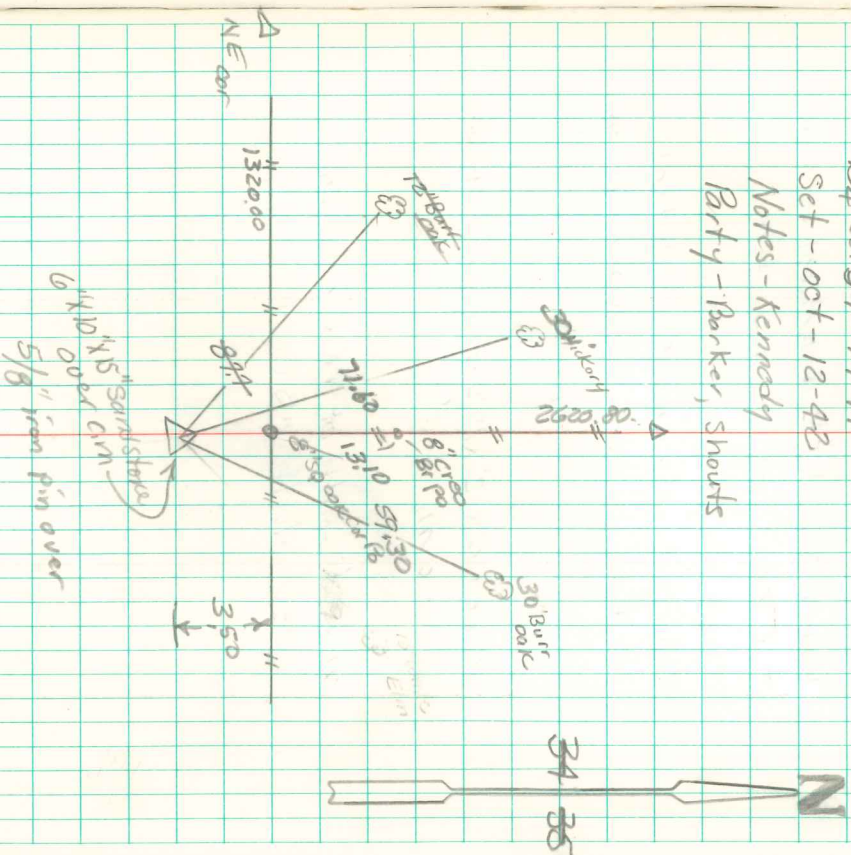

Retief 3/25/08  
 Absie Davis