

Found Red Diamond shaped
 Sandstone 24" x 14" x 4" & 2-2" D tile
 Set c.m. over 1-2" D tile & Placed
 Sandstone on top c.m.
 c.m. 20" Below surface

N.E. Cor 34-74-19
 Set-7-18-40
 Notes - original

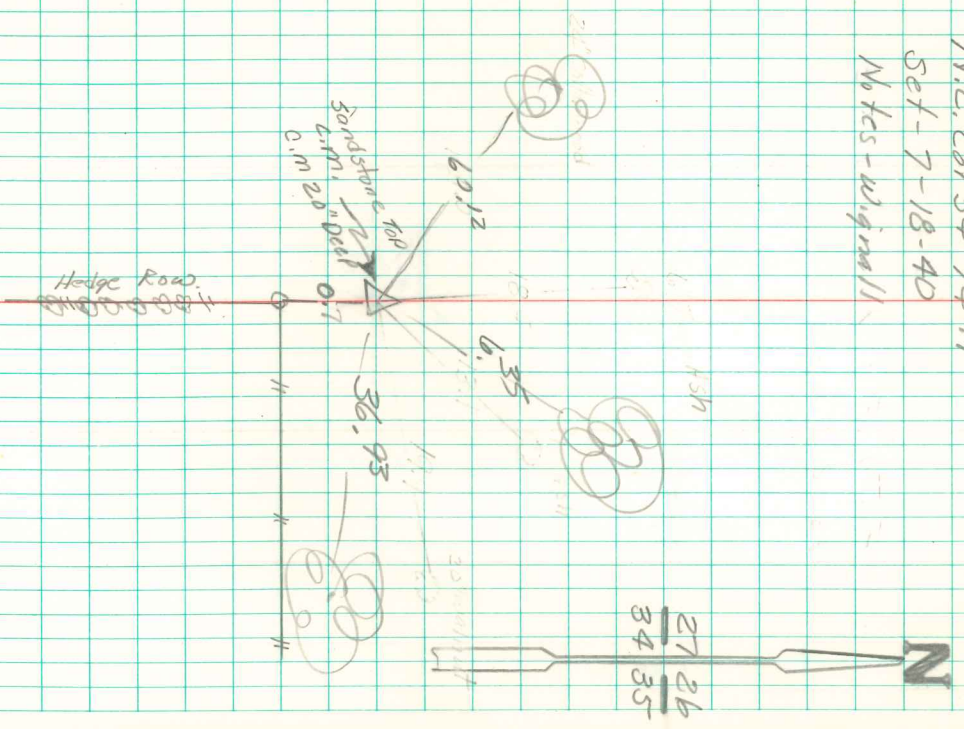

See certificate in 26-74-19

2/14/03