



Document 19-3012

Book 2019 Page 3012 Type CORNR Pages 1
Date 7/17/2019 Time 9:34 AM
Rec Amt \$7.00

KAREN SCHWANEBECK, RECORDER
MARION COUNTY IOWA

Prepared by Abie C. Davis, P.E. & L.S., 1428 Oregon St., Knoxville, IA 50138 (641) 842-5863

UNITED STATES PUBLIC LAND SURVEY CORNER CERTIFICATE OF

Land survey Monuments situated in Section 4, Township 74N, Range 19W, of the Fifth Principal Meridian, Marion County, Iowa.

Previously recorded in Bk 1, Pg 56 in County Recorders Office.

Show reason for preparing this certificate, the evidence and detailed procedures used in establishing the corner positions and monumentation found or placed

Monument Description and Remarks: Found Iron Pin over
CM set out current ties

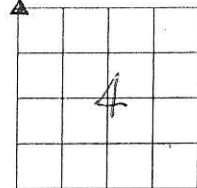

PLAN - VIEW

(Show a minimum of three reference ties to durable physical objects, relevant monuments and physical conditions that will enable recovery of the corner.)

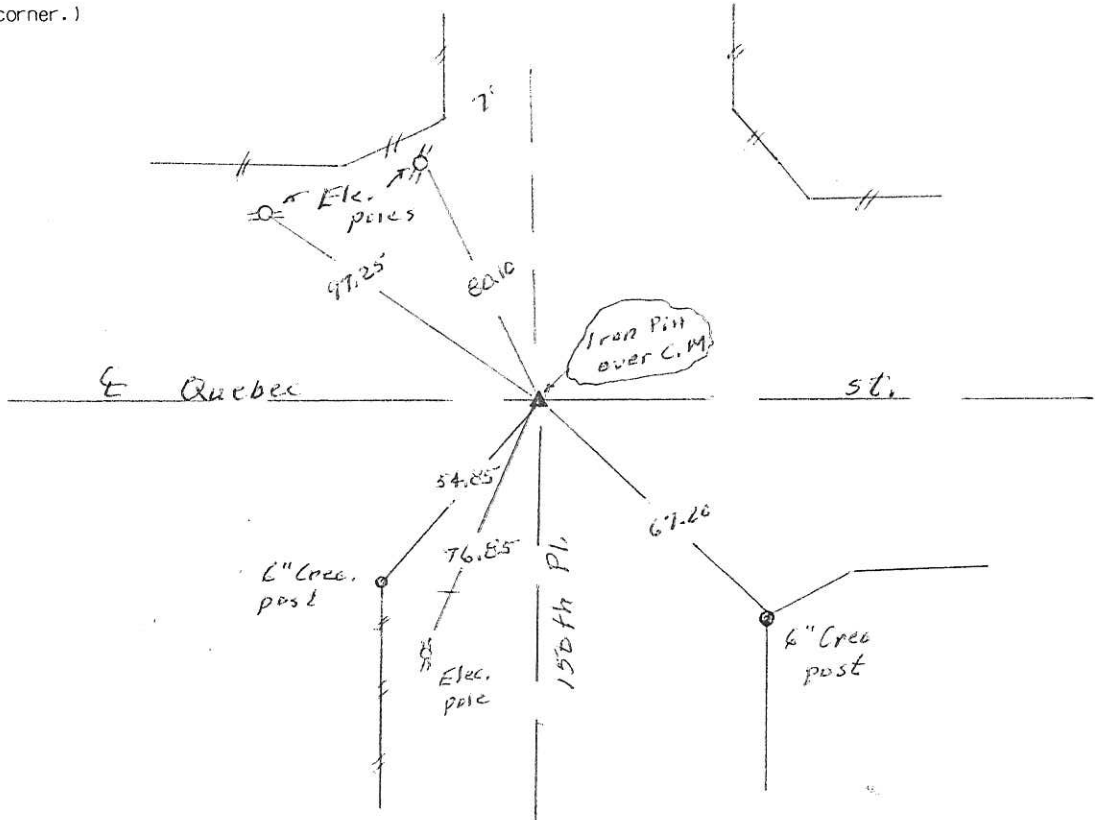

I hereby certify that the survey work was completed and this land surveying document was prepared by me or under my direct personal supervision and that I am a duly licensed land surveyor under the laws of the state of Iowa

Signature: Abie C. Davis

Abie C. Davis, P.E. & L.S.

Date: 7/15/19 Reg. No. 5594

My license renewal date is December 31, 2019

SEAL



List Corners to be Indexed

Corners	Section	Twp	Range
NW	4	74N	19W

Pds 100 Cash - Ret Abie Davis

Found Lime stone 7"x8"x9"
 1/2"x12" Iron Rod, 3-3" Conc. Tile
 Filled with sand Rock

Placed Tile N. & S. under C.M.
 Stone & Iron Rod on N. side C.M.

N.E. Cor 5-74-19

Set - Nov-29-41

Notes - Jackson - Thomas

