

INDEX LEGEND

COUNTY: MARION
SECTION: 14, T-75N, R-20W
CORNER: SE COR., NE 1/4, SE 1/4

SURVEYOR & SURVEY COMPANY:
Jason S. Lowry, P.L.S.
Lowry Land Services, L.L.C.
752 Diamond Trail Rd., Searsboro, Iowa 50242

PREPARED BY AND RETURN TO:
Jason S. Lowry, P.L.S.
752 Diamond Trail Rd., Searsboro, Iowa 50242
(641) 521-1160, lowrylandservices@gmail.com

Instr. Number: 22-263
BK: 2022 PG: 263
Recorded: 1/14/2022 at 10:52:14.0 AM
County Recording Fee: \$7.00
Iowa E-Filing Fee: \$3.13
Combined Fee: \$10.13
Revenue Tax:
KAREN SCHWANEBECK, RECORDER
Marion County, Iowa

UNITED STATES PUBLIC LAND SURVEY CORNER CERTIFICATE
Land Survey Monuments situated in Section 14, Township 75 North, Range 20 West of the Fifth Principal Meridian, Marion County, Iowa. Not previously recorded.

MONUMENT DESCRIPTION & REMARKS

SE Cor., NE 1/4, SE 1/4 - Set 5/8" x 18" pink plastic capped rebar, P.L.S. #22291, at midpoint and on line between E 1/4 Cor. & SE Cor.. This position fit the existing fence line going west.

No certificate of record. This corner was used for a plat of survey in the NW 1/4 of the SE 1/4 of Section 14.

PLAN VIEW

No Scale

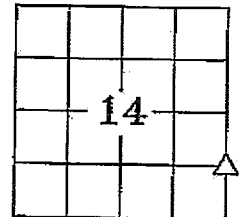

SE Corner
NE 1/4 of the SE 1/4
Section 14

Set 5/8" x 18" pink plastic capped rebar, P.L.S. #22291

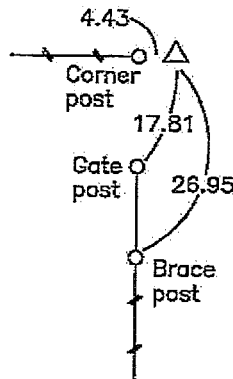

NOTE: ALL TIES ARE PLUMB MEASUREMENTS TO ORANGE SURVEY MARKER UNLESS NOTED.

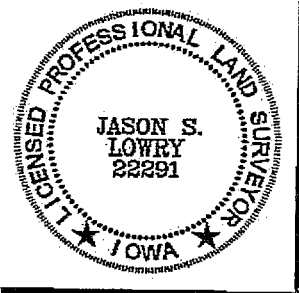

I hereby certify that this land surveying document was prepared and the related survey work was performed by me or under my direct personal supervision and that I am a duly Licensed Land Surveyor under the laws of the State of Iowa.

My license renewal date is 12/31/2023

Pages covered by this seal: 1 - 1

Jason S. Lowry
Jason S. Lowry Iowa Lic. No. 22291 1/14/22 Date

LEGEND

- ▲ Section Corner Found
- △ Section Corner Set
- Existing Fence

LAND CORNERS TO BE INDEXED

Land Corner	Section	Township	Range
SE Corner NE 1/4, SE 1/4	14	75	20

LOWRY LAND SERVICES, L.L.C. 752 DIAMOND TRAIL RD., SEARSBORO, IOWA 50242, 641-521-1160

PROJ. NO. 0822 DATE OF SURVEY: 01/03/22 CERT NO. 2/6