

N.E. Cor 25-75-20

Set - 11-1-39

Notes: Kennedy

24
19
25 30

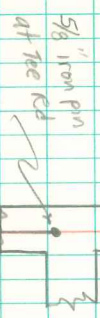

2603, 68' stop over can.

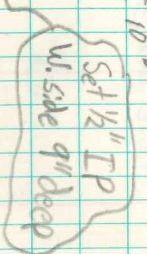

Found Sandstone 8"x8"x4"
over 1-2 1/2" dia tile

Set C.M. over 1-2 1/2" dia tile &
Placed stone over C.M.

C.M. 19" Deep

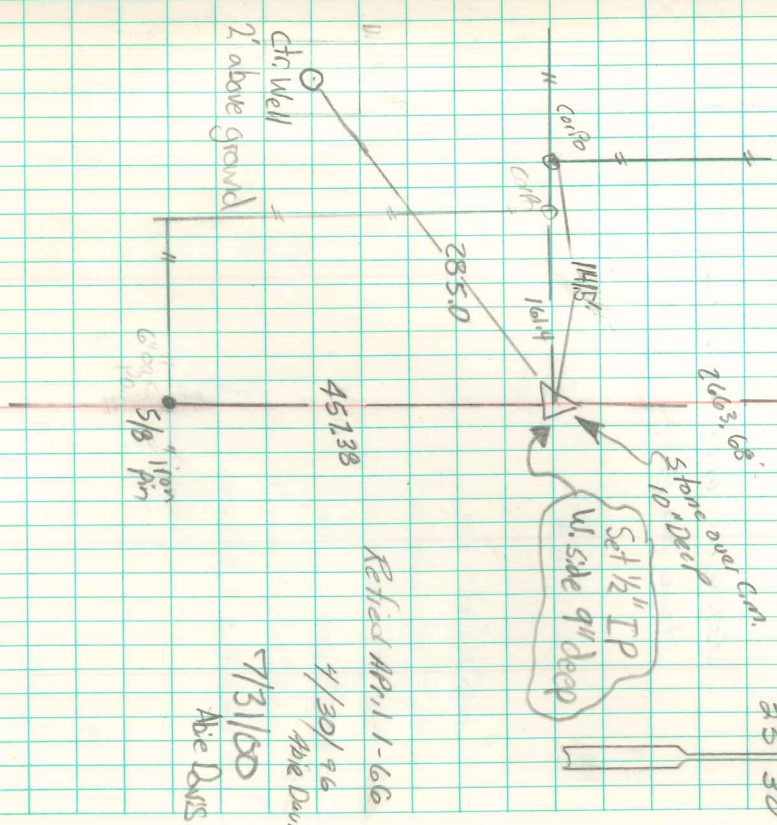

Ret'd APR. 1-66

4/30/96
Able Davis

7/31/50

Able Davis

45138

285.0

60' 80'

C.M.

1415'

10' 11"

2' above ground
C.M. Well

6' 00" pin
5/8" iron pin

N