

N.E. Cor Sec 33-75-20
Set, Oct 10 - 1958
Notes: R.C. Dinsing, Randolph Ave

N
89 28
32 33

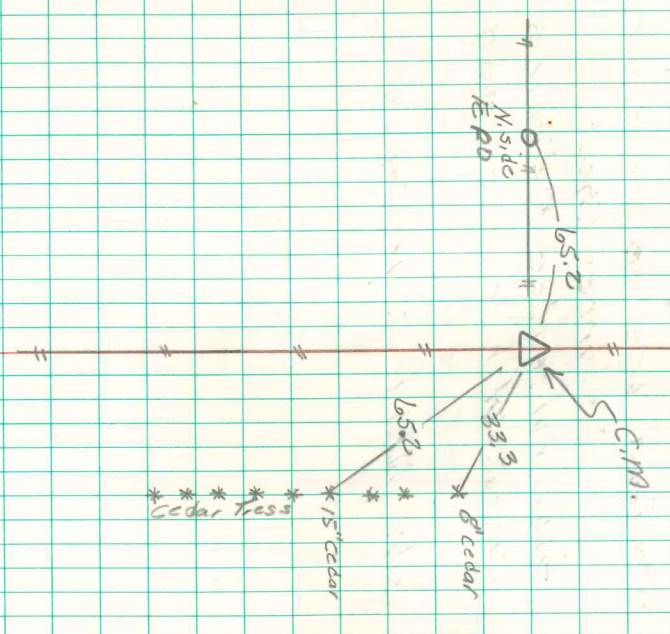

Chained Distance From N.E. Cor 33
 § N. & Cor 33. Distances Given on
 Old Plat. Chained Given distance
 From E. & Cor Sec 33,
 Set C.M. in approximate ctr.
 old Road in line with R. west.
 Platted Distances Checked Good.
 Staked Fence line N. & South as
 Division of Abandoned Road
 Left C.M. 6" Above Ground