



Document 19-4357

Book 2019 Page 4357 Type CORNR Pages 1
Date 9/25/2019 Time 9:41 AM
Rec Amt \$7.00

KAREN SCHWANEBECK, RECORDER
MARION COUNTY IOWA

Prepared by Abie C. Davis, P.E. & L.S., 1428 Oregon St., Knoxville, IA 50138 (641) 842-5863

UNITED STATES PUBLIC LAND SURVEY CORNER CERTIFICATE

OF
Land survey Monuments situated in Section 29, Township 75N, Range 21W, of the Fifth Principal Meridian, Marion County, Iowa.

Previously recorded in N/A in County Recorders Office.
(book, page, document number, etc.)
Show reason for preparing this certificate, the evidence and detailed procedures used in establishing the corner positions and monumentation found or placed

Monument Description and Remarks: Corner mon. was destroyed in culvert replacement constr. Reset using old ties from Co. Engr. tie books.

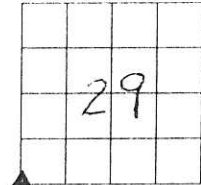

PLAN - VIEW

(Show a minimum of three reference ties to durable physical objects, relevant monuments and physical conditions that will enable recovery of the corner.)

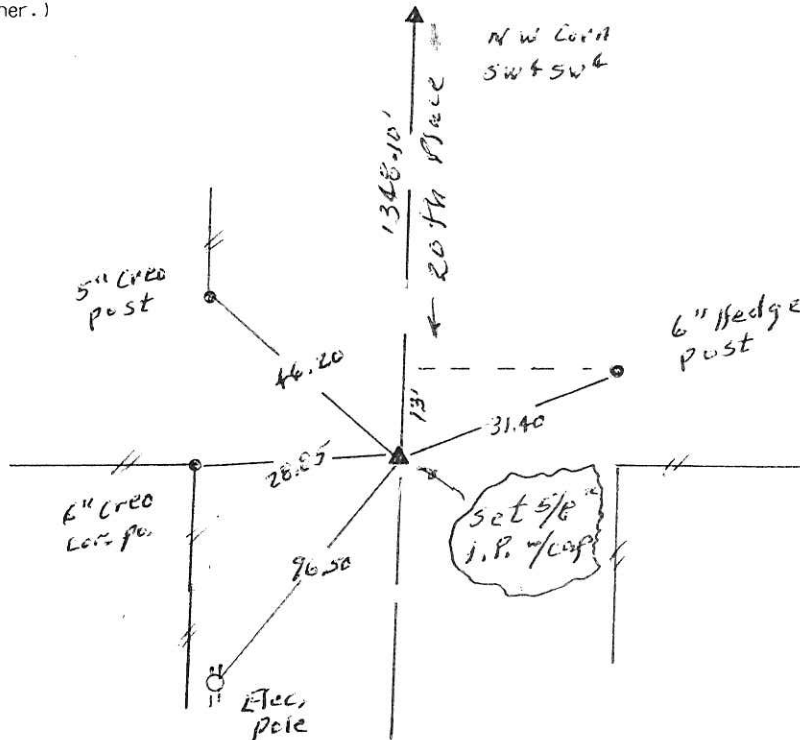

I hereby certify that the survey work was completed and this land surveying document was prepared by me or under my direct personal supervision and that I am a duly licensed land surveyor under the laws of the state of Iowa

Signature: Abie C. Davis

Abie C. Davis, P.E. & L.S.

Date: 9/24/19 Reg. No. 5594

My license renewal date is December 31, 2019

SEAL



List Corners to be Indexed			
Corners	Section	Twp	Range
SW	29	75N	21W

PL \$700 Cash - Ret Abie Davis

Found 6"x8"x14" yellow sandstone
in vertical position over a number
of broken bricks.

Lowered broken bricks & set c.m.
over them.

c.m. on the south edge of 15"
corrugated culvert.

Placed 4"x6"x8" granite rock
over c.m.

N.E. Cor 31-75-21

Set - Sept-2-1940

Notes - E.R. Barker

Party - Nandell, Kennedy & Frazier

