

Found sandstone 20" x 10" x 8"
 over 2-2" A tile (Watkins tile)
 Right where we set MON.

Set mon. over original tile took
 one out mon. flush with ground

N 1/4 con. 34-75-27
 Set: 10-14-40

Party: Sharp, Hanger
 Notes: Kennedy

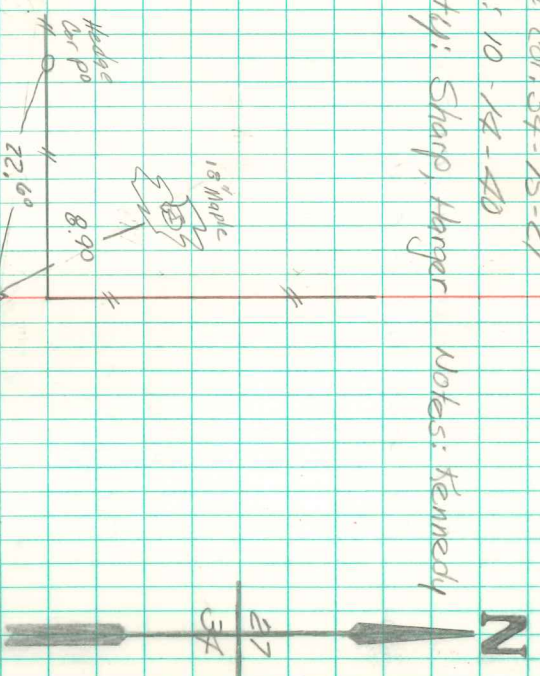

10" maple

2631.2 E. 40 CM

Found 4' x 4' Cove. Mon.
 w/ brass cap on S. side
 Brian Morrissey 8/5/01