

Found Sharpen stake on East side
of a Granit Rock 16"x8"x8"

Put Pieces of Crockery at base B
c.m.

E $\frac{1}{4}$ Cor 11-76-20

Set - 9-30-41

Notes = Kennedy

Party - Shore, Luther

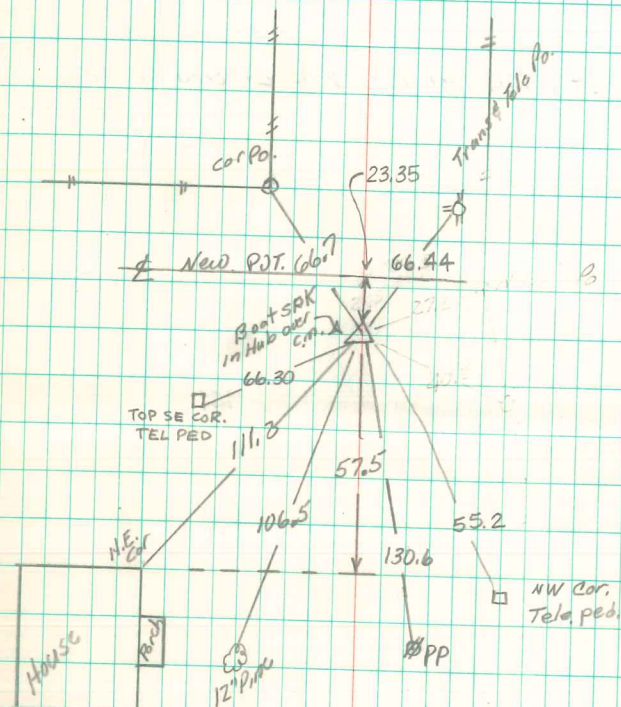

Retied 11/30/98
RETIED 4/7/2015
HATCH, VANDER WERT

Found sharpen stake on East side
of a Granit Rock 16"x8"x8"

Put pieces of Crackery at base of
c.m.

E $\frac{1}{4}$ Cor 11-76-20

Set - 9-30-41

Notes = Kennedy

Party - Shore, Luther

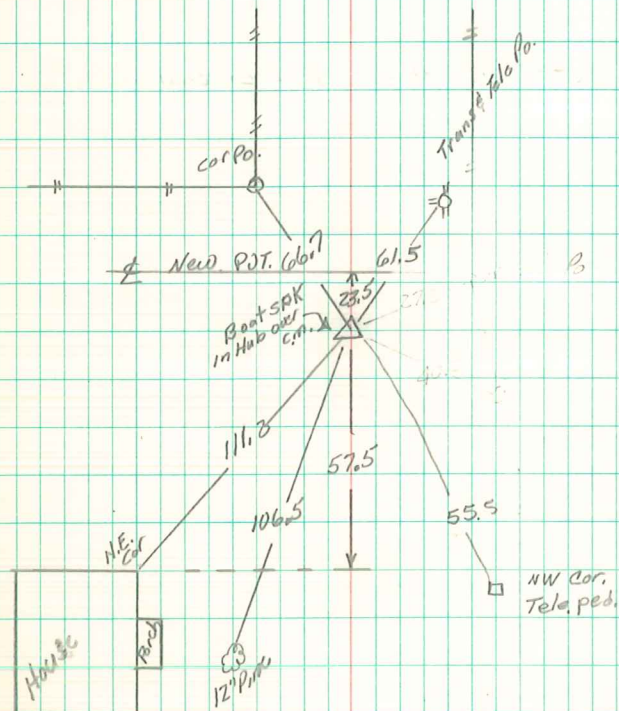

Retired 11/30/98