

True Corner. set C.M. over
2" \square tile on END placed 2
stones on top C.M. 1. stone
Point above Ground.

Witness Cor, we Found 2-2" \square tile
& 1 Piece 4" Long

Lowered 1-2" \square tile in Place
& set C.M. witness mon.
& Put 2-stones on top C.M.
Point above surface

N.E. Cor sec 18-76-20

Set - 5-24-40

Notes: Wignall

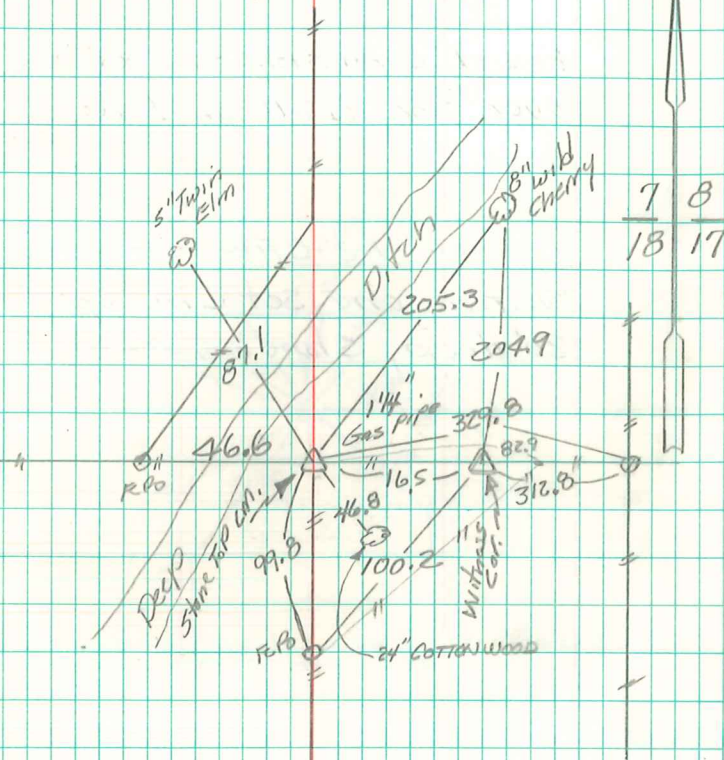

Retired 12/2/96