

Found Sandstone 22" x 8" x 5" and
one 2' Horse Shoe Tile

Lowered Tile in Place and set
Cone. mon.

Paced Stone on North side of
C.M. Point above Surface of
Ground.

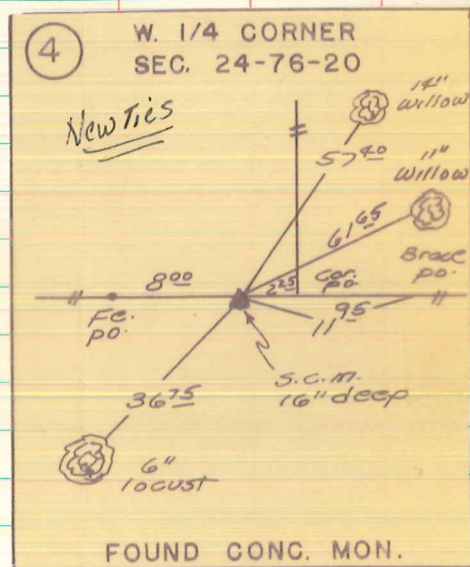

or W/4 24-76-20
E 1/4 Cor sec 23-76-20

Set- 4-18-40

Notes: Kennedy - Wignall, open
shore, Eddinger.

these trees
VOID

see
insert

