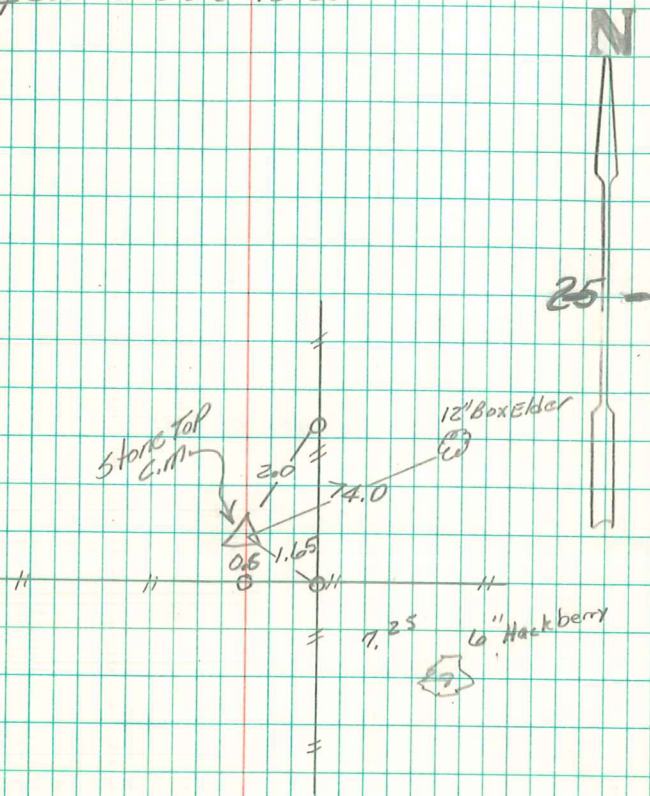

E $\frac{1}{4}$ Cor sec 25-76-20

End CM 12" deep, Set $\frac{5}{8}$ "
 iron Pin over
 Laid $\frac{1}{2}$ " x $\frac{10}{16}$ " x 3" Sandstone
 E of iron pin.
 Abie Davis 1/8/02

Found Stone 18" x 12" x 2" &
2- 2 1/2" Tile

set C.M. over Tile Horiz: N&S.
Stone on south side C.M.

E 1/4 Cor Sec 25-76-20

Set - 11-7-39

Notes: Wignall-Koons, Russell
& Eddinger

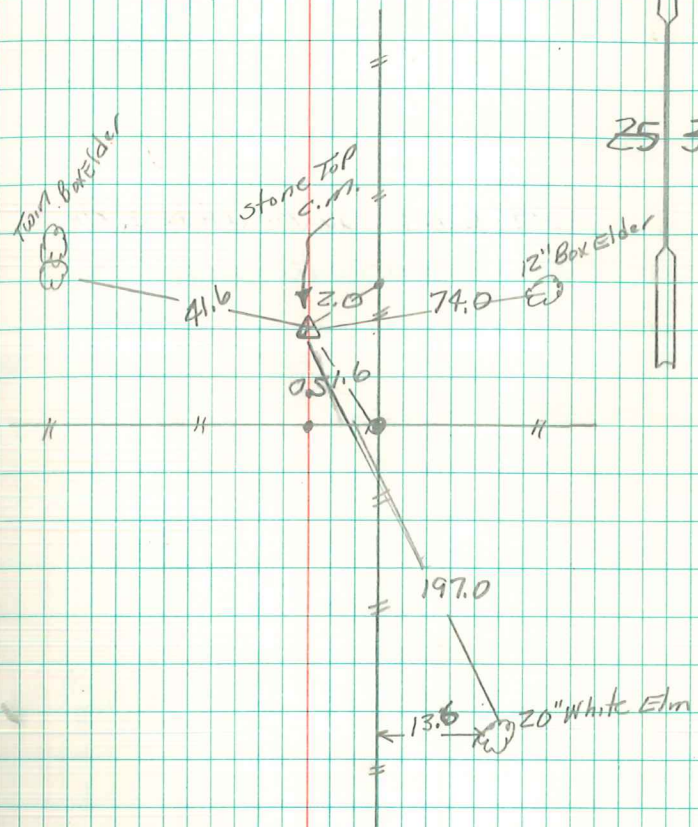

25 30