

Found Sandstone 6"x4"x4"
over 3-2" DTile

Set C.M. over 1-3" DTile Lowered
in Place.

Stone on Top C.M.

C.M. 14" below TOP Surface

Set $\frac{5}{8}$ " iron pin on W. edge 2" Hub

E $\frac{1}{4}$ Cor 29-76-20

Set 10-16-40

Notes: Kennedy

Party - Wells, Burrus, Hew. H & Crozier

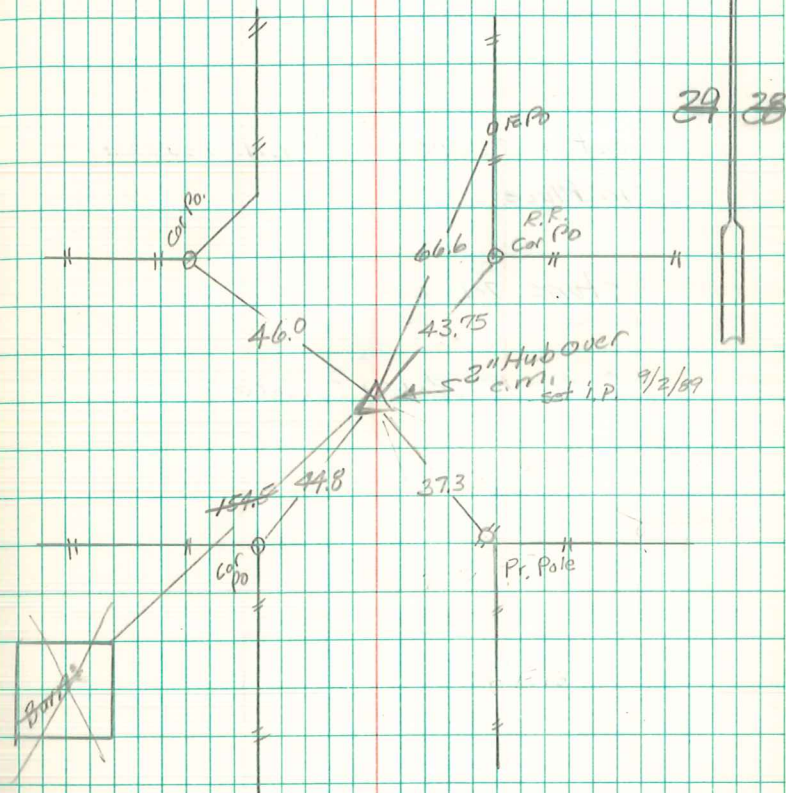

RETRD by ABIE DAVIS
2/18/91