

Center Sec. 22-79-18

N

End. 5" x 12" x 15" Triangular Limestone
8" Deep in Old Fence line, Lowered
Stone to 15" Deep, Stone Shattered
Somewhat when lowered

5/8" x 36" Rebar S side of
Stone. 60d Spike above stone

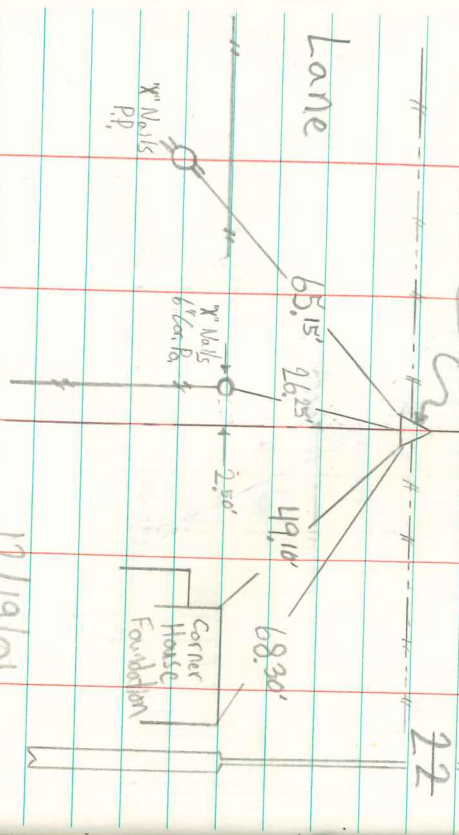

12/19/01
Randal Mayhew