

KAREN SCHWANEBECK, RECORDER  
 MARION COUNTY IOWA

**G1** GARDEN & ASSOC. P.O. Box 451, Oskaloosa, Iowa 52577-0451 Phone: (641)672-2526

UNITED STATES PUBLIC LAND SURVEY CORNER CERTIFICATE  
 OF

Land Survey Monuments situated in Section 24, Township 77, Range 18,  
 of the Fifth Principal Meridian, Marion County, Iowa.  
 Previously recorded in NO CERTIFICATE OF RECORD in County Recorder's Office.  
 Monument Description and Remarks: SEE BELOW

\_\_\_\_\_  
 \_\_\_\_\_  
 \_\_\_\_\_

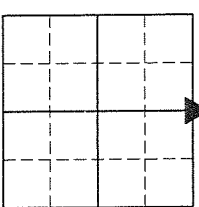

NORTH 1/4 COR

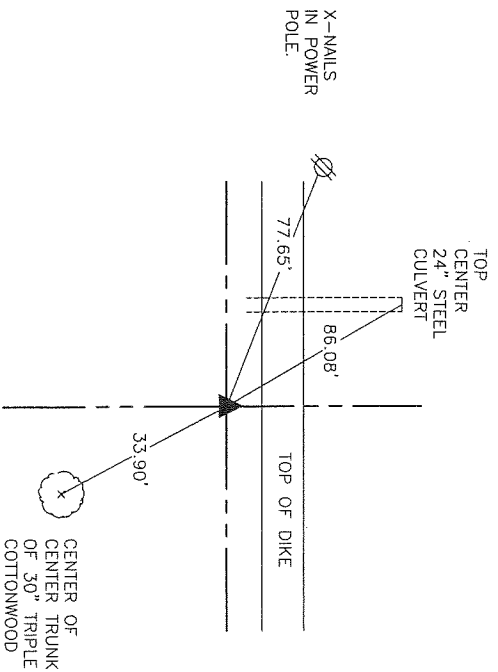

CORNER FALLS ON THE SLOPE OF A DIKE ALONG THE SKUNK RIVER AND WAS MOST LIKELY OBLITERATED BY THE CONSTRUCTION OF SAID DIKE. DOUBLED DOWN THE DISTANCE FROM THE LIMESTONE AT THE CENTER OF SECTION 13-77-18 (BOOK 1 PAGE 179) THROUGH THE FENCE CORNER AT THE SE CORNER OF THE NE-SW OF SAID SECTION 13 AND SET A 5/8" X 30" REBAR # 19960 FLUSH.

I hereby certify that this land surveying document was prepared and the related survey work was performed by me or under my direct personal supervision and that I am a duly licensed Professional Land Surveyor under the laws of the State of Iowa.

Bobby J. Maddaleno PLS 11-14-14  
 Bobby J. Maddaleno, P.L.S. Date

License number: 19960

My license renewal date is December 31, 2015

SEAL



List Corners to be Indexed  
 Corners Section Township Range  
 NORTH 1/4 COR. 24 77 18

PLS 700 ck. For Garden & Assoc