

N.E. Cor 25-77-18
Set - 9-7-39
Notes: Wignall

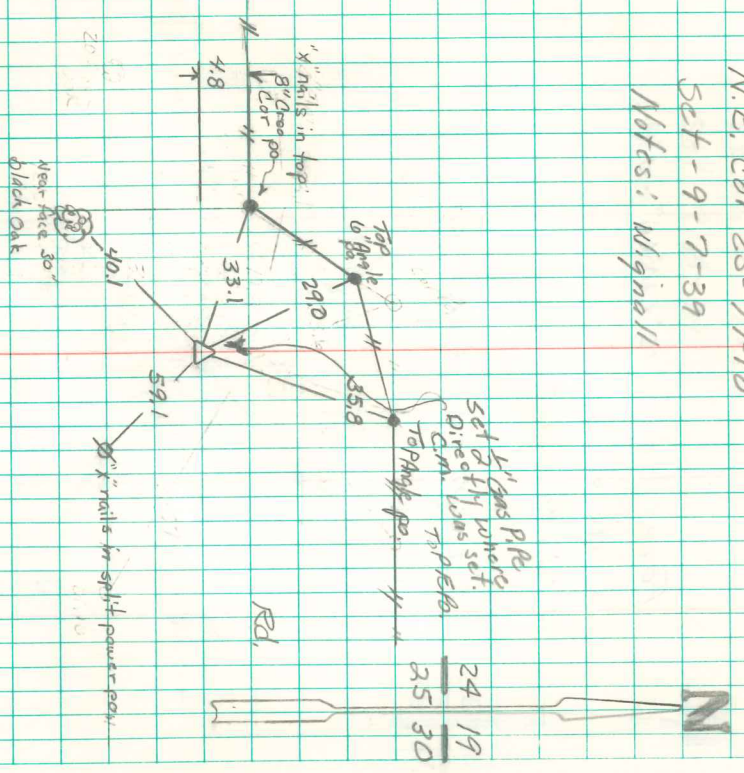

C.M. Destroyed by
Construction

Ed 1/2" gas pipe w/ limestone fragments 12" deep in
forestage, Set 1/2" x 24" rebar beside pipe. Set 1/2 x 12"
near above. 6 Nov 1991
Stanley Eng.

Found Stone 30"x20"x6"

Set C.M. over Broken Crockery
" Stone on North Side C.M.