

N. 1/4 Cor 31-77-18

Set - 3-13-41

Notes: Kennedy

Party = Shore & Mitchell

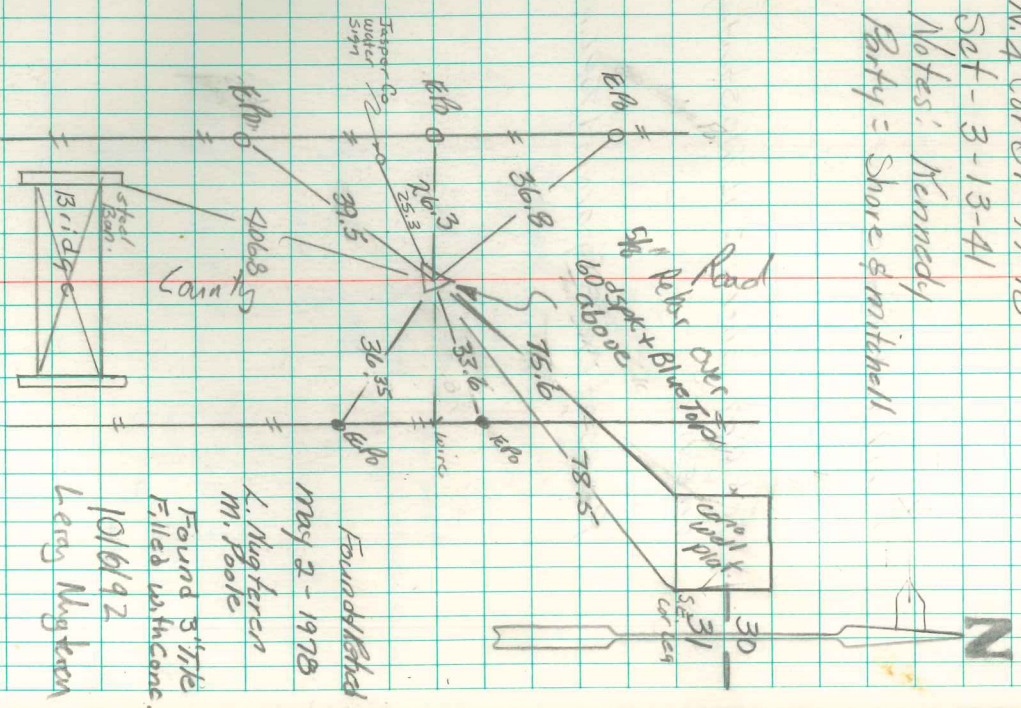

Found a Piece of 3" Drain Tile  
 6" Long Filled with Pieces of  
 Broken 3" Tile & Concrete over  
 4" Wide 3' Deep Filled with Rock  
 Pieces Brick Pieces tile & concrete  
 Set C.M. over Pieces of Broken  
 Tile & Concrete  
 Placed Some Pieces of Rust Top  
 C.M.