



Document 21-1606

Book 2021 Page 1606 Type CORNR Pages 1
Date 3/16/2021 Time 11:04 AM
Rec Amt \$7.00

KAREN SCHWANEBECK, RECORDER
MARION COUNTY IOWA

Prepared By: J. Brian Morrissey, Morrissey Surveying & Consulting, LLC, 1405 Hwy. G28, Otley, Ia. 50214, 515-480-2531

UNITED STATES PUBLIC LAND SURVEY CORNER CERTIFICATE
CORRECTED **OF** **CORRECTED**

Land Survey Monuments situated in Section 33, Township 77N, Range 18W, of the Fifth Principal Meridian, Marion County, Iowa.
Previously recorded in N/A in the County Recorder's Office.

(book, page, document number, etc.)

(Show reason for preparing this certificate, the evidence and detailed procedures used in establishing the corner positions and monumentation found or placed.)

Monument Description and Remarks: Set 5/8" X 18" orange plastic capped rebar, P.L.S. #7995, at midpoint and on line between found Center and N 1/4 Corner of Section 33.

This Corner was used for a Plat of Survey in the SE 1/4 of the NW 1/4 of Section 33.

PLAN VIEW

(Show a minimum of three reference ties to durable physical objects, relevant monuments and physical conditions that will enable recovery of the corner.)

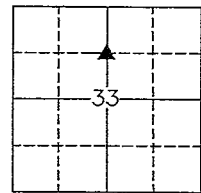
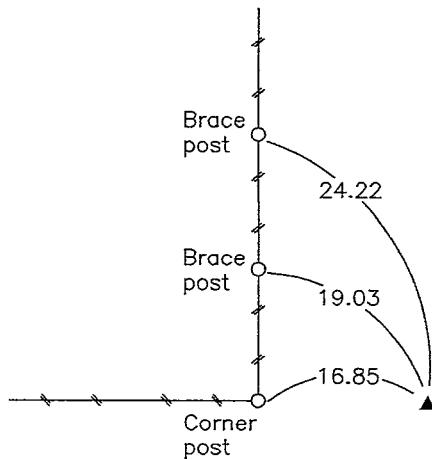

Set 5/8" x 18"
orange plastic
capped rebar,
#7995



NE Cor., SE 1/4 of the NW 1/4, Section 33

Date of Survey: 11/3/20

NOTE: ALL TIES TO BRASS DISK OR YELLOW/ORANGE SURVEY MARKER UNLESS NOTED.



I hereby certify that this land surveying document was prepared and the related survey work was performed by me or under my direct personal supervision and that I am a duly Licensed Land Surveyor under the laws of the state of Iowa.

Signature: J. Brian Morrissey Date: 3/15/21
J. Brian Morrissey

License number 7995.

My license renewal date is December 31, 2021

1035-19-1/1

* Recorder's Note: Previously recorded in Book 2021 Page 1511 to Correct the name of County.

pd. # 7 - Call Ret Brian Morrissey